

Range Chart

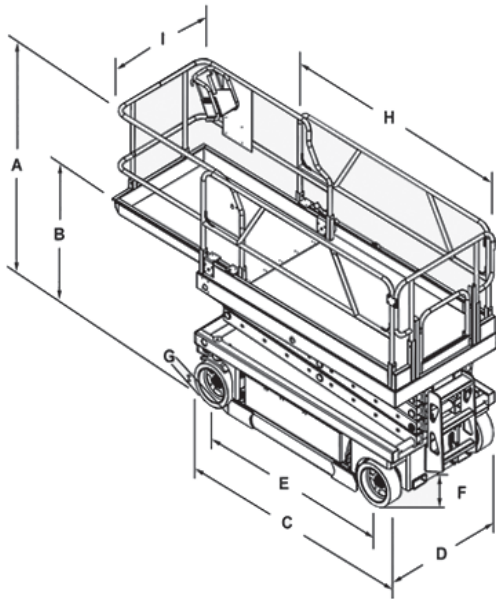

32' HAULOTTE SCISSOR LIFT ELEC

For more information on this equipment or if you require a free onsite inspection, contact our team

136 132

Specifications

Working height	12.00 m
Platform height	10.00 m
(A) Height stowed	2.38 m
(B) Height stowed (platform)	1.26 m
(C) Unit length - stowed	2.31 m
(D) Unit width	1.20 m
(E) Wheelbase	1.86 m
(F) Ground clearance	0.13 m
(G) Platform width	1.20 m
(H) Platform length	2.30 m
Lift capacity	150 kg
Turning radius outside	2.50 m
Turning radius Inside	0.20 m
Gradeability	23%
Overall weight (approx)	2630kg